

Features:

- Wall-mount spare toilet paper holder
- Includes mounting hardware
- Plated brass construction

Finish Options:

- PS - polished brass
- PB - polished bronze
- CR - polished chrome
- PN - polished nickel
- BK - black chrome
- TN - titanium
- 51 - brushed brass
- BB - brushed bronze
- BG - brushed gold
- NI - brushed nickel
- GM - gun metal
- 44 - matte black

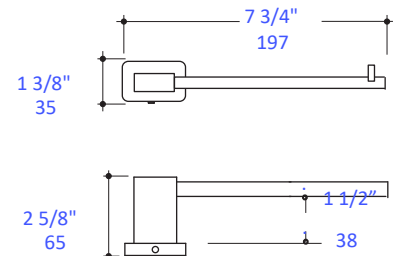

Paper roll space width max. 3 7/8" (100mm)

Recommended Accessories:

- Item #1801: Wall-mount towel bar
- Item #1806: Wall-mount double towel bar
- Item #1808: Wall-mount toilet paper holder or towel ring
- Item #1811: Wall-mount towel ring
- Item #1813: Wall-mount double robe hook
- Item #1813S: Wall-mount single robe hook

LACAVA reserves the right to revise any dimension or information on this sheet without notice. Dimensions are nominal and may vary within an industry accepted tolerance of 1/4". Drawings provided herein are meant to give the user an idea of the product and are not made to scale. Location of plumbing is meant for reference, your specific application may vary.

Revised: 04/14/2026