



HYDROTAP[®] TOUCH-FREE WAVE FOR HOME*

CHILLED | SPARKLING

Ditch the bottles and skip the sparkling water in cans when you upgrade your home or office hydration with the HydroTap Touch-Free Wave. Enjoy filtered chilled and sparkling water from a single, touch-free tap.

*For home or small office (maximum office size = 10 people)

HYDROTAP® TOUCH-FREE WAVE

CHILLED | SPARKLING



HYDROTAP TOUCH-FREE WAVE FOR HOME OR SMALL OFFICE* - TAP SPECS

Style	HydroTap Touch-Free Wave for Home or Small Office*
Hole Size	1 3/8"
Available Finishes	Chrome
Installation	Over sink or on drip tray (optional - see below for font)
Flow rate	Max 1.8gpm
Sparkling Water Flow Rate	0.36gpm

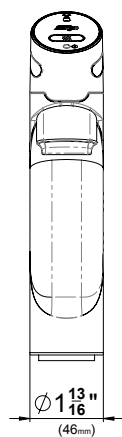

FRONT VIEW

*Not to Scale

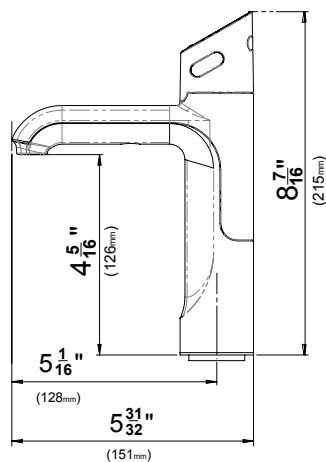

LHS SIDE VIEW

*Not to Scale

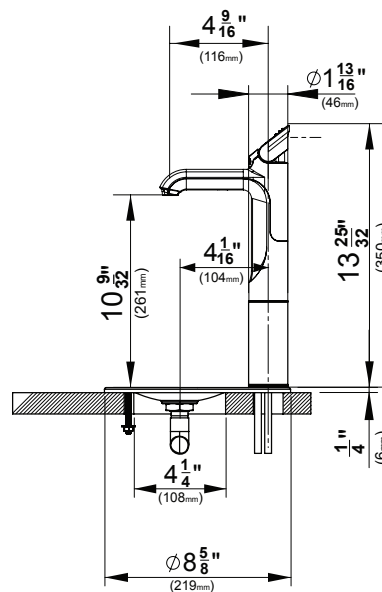

FONT VIEW

*Not to Scale

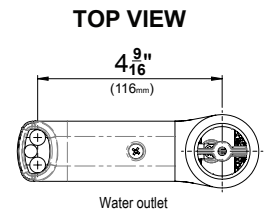

TOP VIEW

Cutting Detail: Classic/Wave Tap & Font

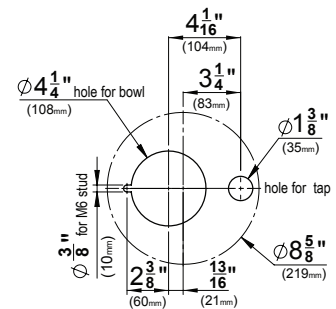

MODEL NUMBERS (CONSULT LOCAL DEALER FOR PRODUCT CODES)

WAVECS120V-CH - Wave (Chrome)

PRODUCT CODE FOR OPTIONAL FONT

01034266 Drip Tray, Classic/Wave Font (Chrome)

PRODUCT CODES FOR ACCESSORIES

01034276	Filter, Zip, 0.2 Micron, 1 Size - 93701	01034347	Zip 2 x 1.5lb CO ₂ refillable/recyclable cylinders
01034277	Filter, Zip, 0.2 Micron, 1.5 Size - 93702	01034348	Zip 1 x 5lb CO ₂ refillable/recyclable cylinders
01034278	Filter, Zip, 3 Micron, 1.5 Size - 93703	01034349	Zip CO ₂ Regulator
01037874	External Scale Installation Kit (includes filter)	01037868	External Scale Filter

*For home or small office (maximum office size = 10 people)

HYDROTAP® 120V COMMAND CENTER

CHILLED | SPARKLING



COMMAND CENTER SPECS

Water Pressure	Min 36psi – Max 100psi with a minimum flow rate of 1 gpm
Water Connection	½" BSP - isolation valve is required within 3' of the installation
Integral Water Values	HydroTaps are fitted with a Dual Check Valve and a 50psi Pressure Limiting Valve
Water Supply Requirements	Potable drinking water supply
Total Dissolved Solids (TDS)	TDS minimum 50ppm – maximum 120ppm
Integral Water Filter	0.2 micron, 1 size - replace every 1,500 gallons or 12 months
Power Rating	110-120V, 60 Hz, 1.25kW, 9A draw
Power Supply Requirements	110-120V, 60Hz 15A power supply with a NEMA 5-15 outlet
Dimensions (WxDxH)	11" X 16" X 13.1"
Minimum Air Gap	Clearances are required - 2" left side , 2" right side , 8" above
Dry Weight	53lbs
Product Approvals	IAPMO - NSF/ANSI 372, 42 & 53, cUL, CEC
Warranty	2 years (1 year Limited Warranty plus additional 1 year warranty is available on product registration)
CO ₂ Cylinder	2 x 1.5lb beverage-grade carbon dioxide cylinder
CO ₂ Capacity	Approximately 450 glasses of sparkling water per 1.5lb CO ₂ cylinder
CO ₂ Operating Pressure	Min 39psi - Max 43psi
Maximum Installation Distance (Tap to Command Center)	3'
Maximum Installation Distance (Tap to Command Center)	15"
Minimum Cabinet Depth	18"

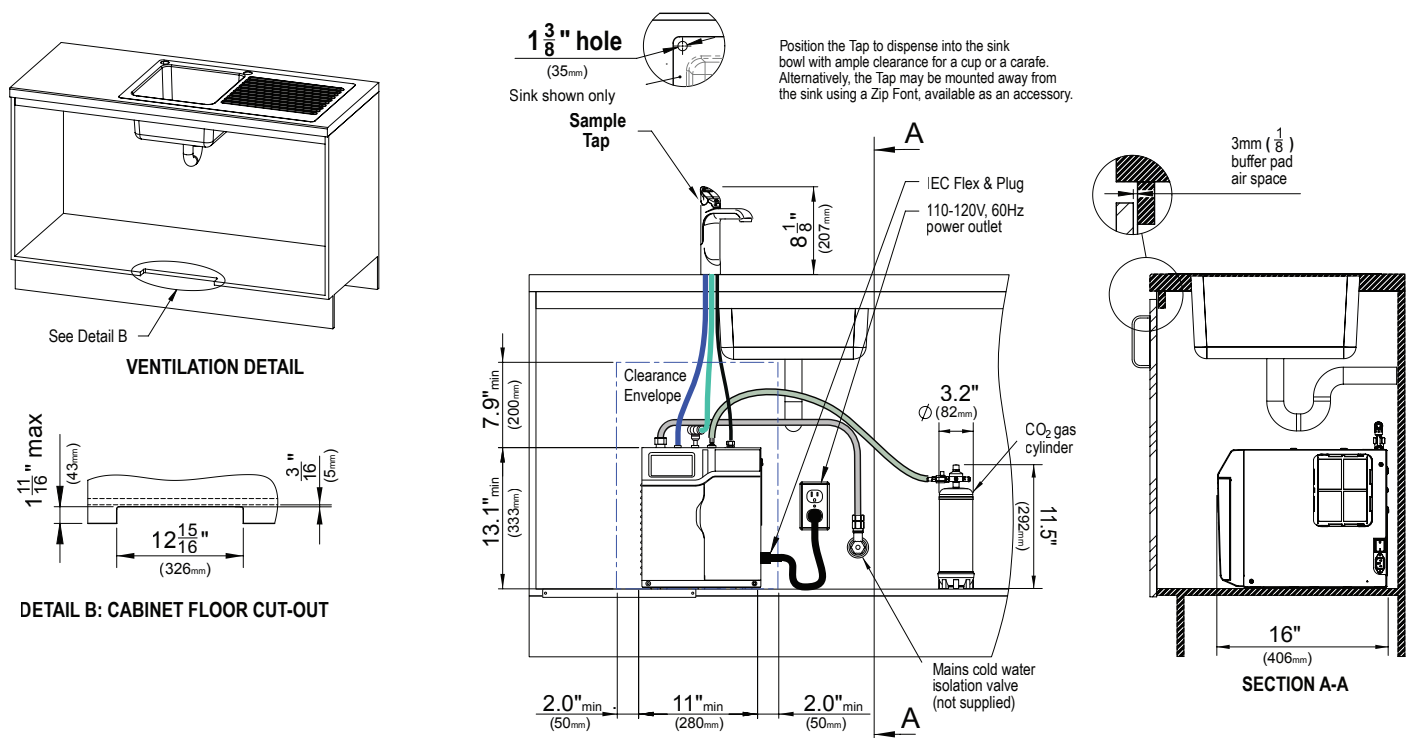

Installation and connection of your HydroTap must be carried out by a qualified person, observing all local, state, & federal regulations. You will require suitable 110 -120V 60Hz 15 amp power supply with a NEMA 5-15 electrical outlet within 3' of the product. The HydroTap is a pump-driven system so the installation of the Tap must be within 3' of the base command center. The HydroTap is an air-cooled system so discrete cabinetry cut-outs are required for ventilation. Installation on most countertops is straightforward however some stone countertops may require a specialized cutting service. If using a drip tray (font) accessory, suitable drainage to a trapped waste is required within 3' of the installation. If you live in an area with hard water (more than 120ppm), we recommend installation of a scale filtration kit. Sufficient space and clearance to install the HydroTap as detailed in the product installation guidelines is required. Installation by Zip Professional Service can be arranged with a phone call to 1-833-233-2358 or through <https://us.zipwater.com>.