

Petra 5

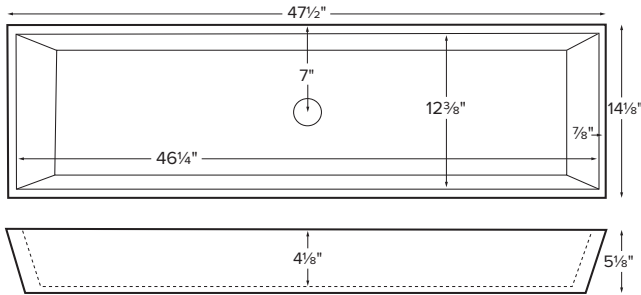

Petra 5 is a single-drain vessel style sink.  
For dual drain, see Petra 6, MTCS-743.



Due to its handcrafted nature, always measure sink on-site to ensure cut-out accuracy.

When ordered as undermount, 1/2" x 3/8" lip detail accommodates most undermount clips (shown right).



**ORDERING AND INSTALLATION**

- 1.5" drain opening
- Optional overflow available for undermount (check local codes)
- Measure on site to achieve the proper cut-out size.
- Lip detail on undermount bowl will accommodate commonly used undermount hardware. Hardware is not included.
- One-piece construction
- Non-porous, stain-, mold- and mildew-resistant SculptureStone®
- Material is approximately 70% organic
- Five-Year Limited Residential Warranty

MODEL 732
47.5" x 14.125" x 5.125" Bowl: 46.25" x 12.375"
VESSEL STYLE or UNDERMOUNT
<b>SculptureStone®</b>
67 lbs / 30 kg

Finish	Part #	Installation	MSRP
soft matte white	MTCS732	vessel	<b>\$1,620</b>
	MTCS732UM	undermount	
hand-polished gloss white	MTCS732GL	vessel	<b>\$2,195</b>
	MTCS732UMGL	undermount	

**Options** Must be ordered at time of purchase

**Biscuit Color Upgrade (SSBISNK) +\$130**  
Additional material colors available for projects only. Please call MTI.

**Exterior Color \$370 (SSCOLSG) Gloss (SSCOLSM) Matte**  
Must specify color code. *Not available for undermount sinks.*  
Sapphire Blue (SB), Blue Lagoon (BL), Terracotta (TC), Onyx (OX), Stratus Gray (TG), Stormgray (SG)

**Quick Ship (QSPRI3) \$280** reduces lead time  
Please call for availability.

**Accessories** Must be ordered at time of purchase

**Teak Sink Tray**  
Slatted (TKST1) **\$205** Solid (TKST2) **\$205**

**Sink Bottom Cover** matching material color  
Matte (BCLMT) **\$715** Gloss (BCLGL) **\$870**  
**Ext. Color for Sink Bottom Cover — Upcharge**  
Matte (SSCOLSBM) **+\$285** Gloss (SSCOLSBG) **+\$285**

**Drain Kits**

**Finger Touch Drain Without Overflow**  
Chrome (DKFGCN) **\$200**, Brushed Nickel (DKFGBNN) **\$205**

**Grid Drain Without Overflow**  
Chrome (DKGDCN) **\$125**, Brushed Nickel (DKGDBNN) **\$195**

**Fixed Drain Without Overflow**  
Chrome (DKFDC) **\$325**

**Options For undermount Sink** Must be ordered at time of purchase

**Integrated Overflow no charge**  
Rear Overflow (SINKIOR), Front Overflow (SINKIOF)

**Drain Kits**

**Finger Touch Drain With Overflow**  
Chrome (DKFGC) **\$200**, Brushed Nickel (DKFGBN) **\$195**

**Grid Drain With Overflow**  
Chrome (DKGDC) **\$140**, Brushed Nickel (DKGDBN) **\$195**

• Before discarding packaging, check for accessories that may be inside.  
• All product measurements are ±1/2".  
• Specifications and configurations are subject to change without notice.  
• Measurements herein supersede all others published prior to publication date below.